



## 110 Hennessy Street Port Campbell VIC

Nestled in the breathtaking landscape of Port Campbell, Lot 8 Arches is your ticket to Victorian coastal living. As one of the last available lots in this flourishing new community, this 545m<sup>2</sup> block of land is a rare gem with a coveted north-facing orientation.

This exceptional property not only provides you with the ideal canvas for your dream home but also embraces the principles of environmental sustainability. Imagine living in harmony with nature while enjoying breathtaking views of Port Campbell countryside. At Arches, we believe in preserving the natural beauty of the coastal character that makes Port Campbell unique.

The development has a focus on sustainability, this

[For full version visit the website](https://www.falk.com.au/sale/vic/great-ocean-rd-otway-ranges/port-campbell/residential/land/8056503)

**Type** : Land  
**Price** : \$330,000 to \$355,000  
**Land Size** : 545 sqm  
**View** : <https://www.falk.com.au/sale/vic/great-ocean-rd-otway-ranges/port-campbell/residential/land/8056503>



**Gary Attrill**  
03 5561 1677

PLAN OF SUBDIVISION

PS 840513J

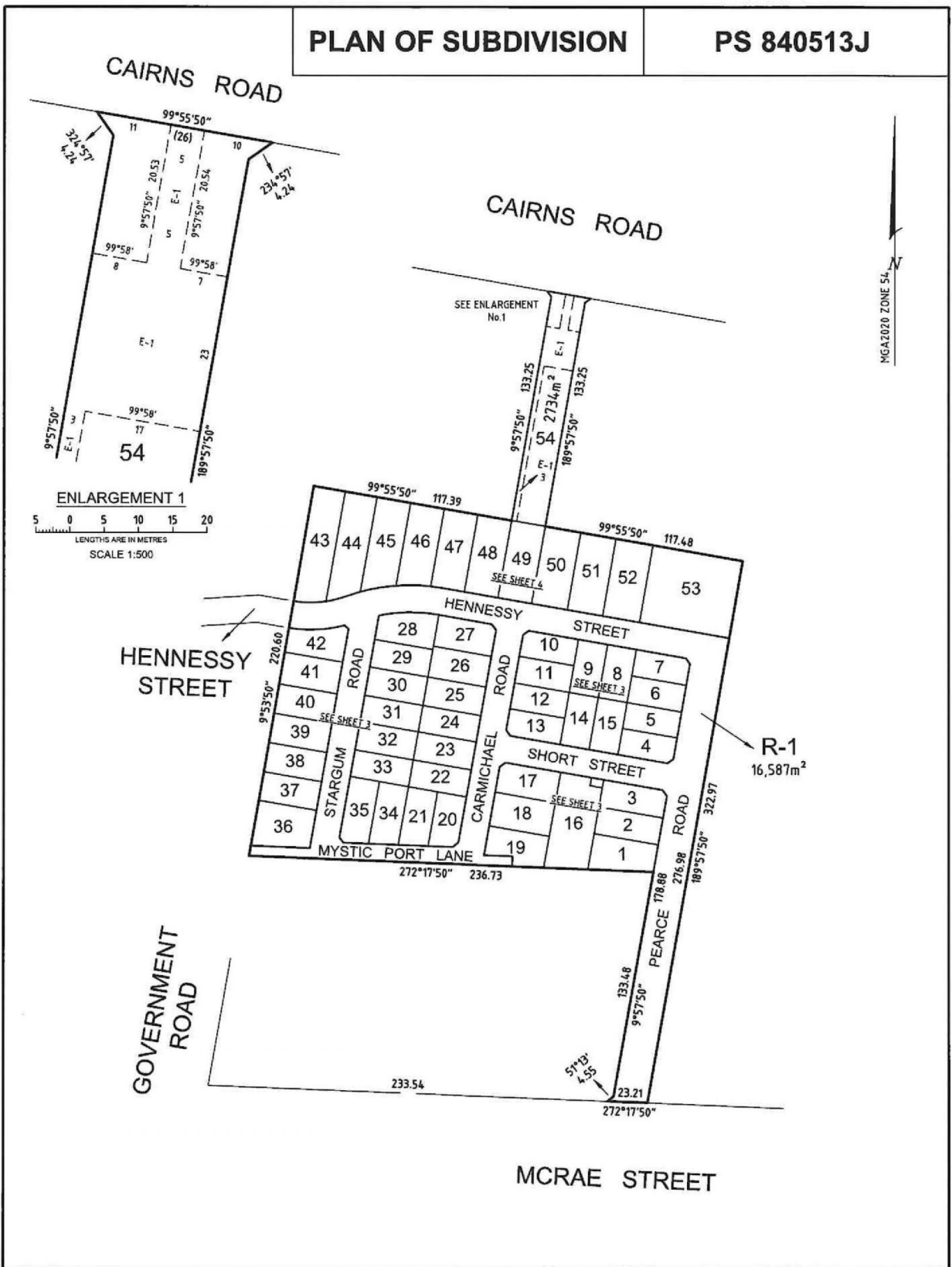

MGA2020 ZONE 54

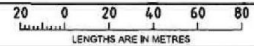
 <p>Smith Land Surveyors Pty Ltd Office - 162a Fyans Street, South Geelong, Vic, 3220 P (03) 5222 1234 F (03) 5223 3141 E survey@smiths.com.au W www.smithlandsurveyors.com.au ABN 72 52 048 964</p>	<p>SCALE 1:2000</p>	 <p>LENGTHS ARE IN METRES</p>	<p>ORIGINAL SHEET SIZE: A3</p>	<p>SHEET 2</p>
	<p>Digitally signed by: Sebastian Wifthycombe, Licensed Surveyor, Surveyor's Plan Version (15), 29/04/2024, SPEAR Ref: S197097M</p>		<p>Digitally signed by: Corangamite Shire Council, 02/05/2024, SPEAR Ref: S197097M</p>	