



## 101 Hennessy Street Port Campbell VIC

Nestled in the breathtaking landscape of Port Campbell, Lot 43 Arches is your ticket to Victorian coastal living. As one of the last available lots in this flourishing new community, this 1261m<sup>2</sup> block of land is a rare gem with a coveted west-facing orientation.

This exceptional property not only provides you with the ideal canvas for your dream home but also embraces the principles of environmental sustainability. Imagine living in harmony with nature while enjoying breathtaking views of Port Campbell countryside. At Arches, we believe in preserving the natural beauty of the coastal character that makes Port Campbell unique.

The development has a focus on sustainability, this

[For full version visit the website](https://www.falk.com.au)

**Type** : Land  
**Price** : \$420,000 to \$460,000  
**Land Size** : 1261 sqm  
**View** : <https://www.falk.com.au/sale/vic/great-ocean-rd-otway-ranges/port-campbell/residential/land/8216753>



**Gary Attrill**  
03 5561 1677

PLAN OF SUBDIVISION

PS 840513J

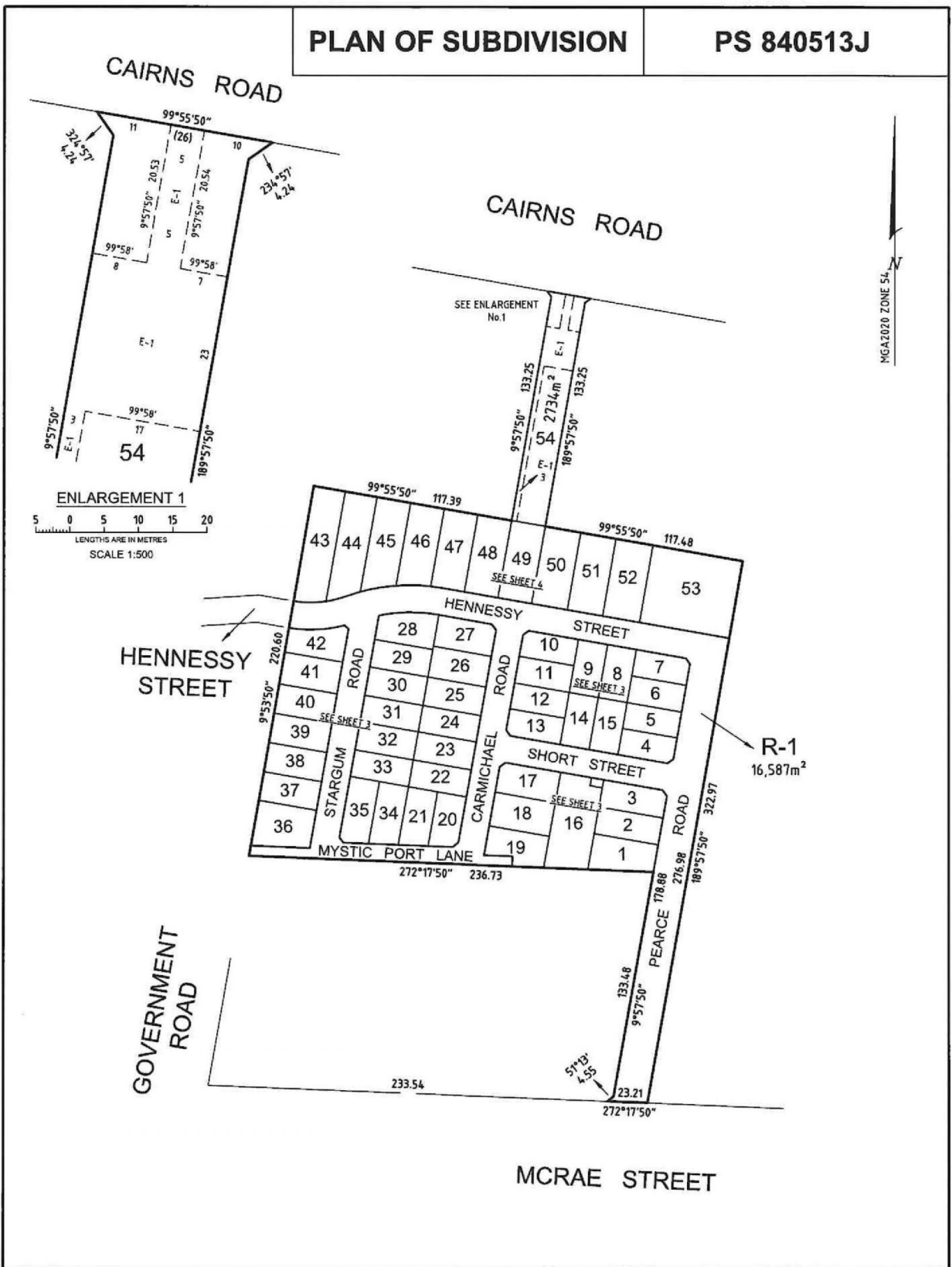

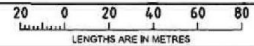
 <p>Smith Land Surveyors Pty Ltd Office - 142a Fyans Street, South Geelong, Vic, 3220 P (03) 5222 1234 F (03) 5223 3141 E survey@smiths.com.au W www.smithlandsurveyors.com.au ABN 72 52 048 964</p>	<p>SCALE 1:2000</p>	 <p>LENGTHS ARE IN METRES</p>	<p>ORIGINAL SHEET SIZE: A3</p>	<p>SHEET 2</p>
	<p>Digitally signed by: Sebastian Withycombe, Licensed Surveyor, Surveyor's Plan Version (15), 29/04/2024, SPEAR Ref: S197097M</p>		<p>Digitally signed by: Corangamite Shire Council, 02/05/2024, SPEAR Ref: S197097M</p>	

PLAN OF SUBDIVISION

PS 840513J

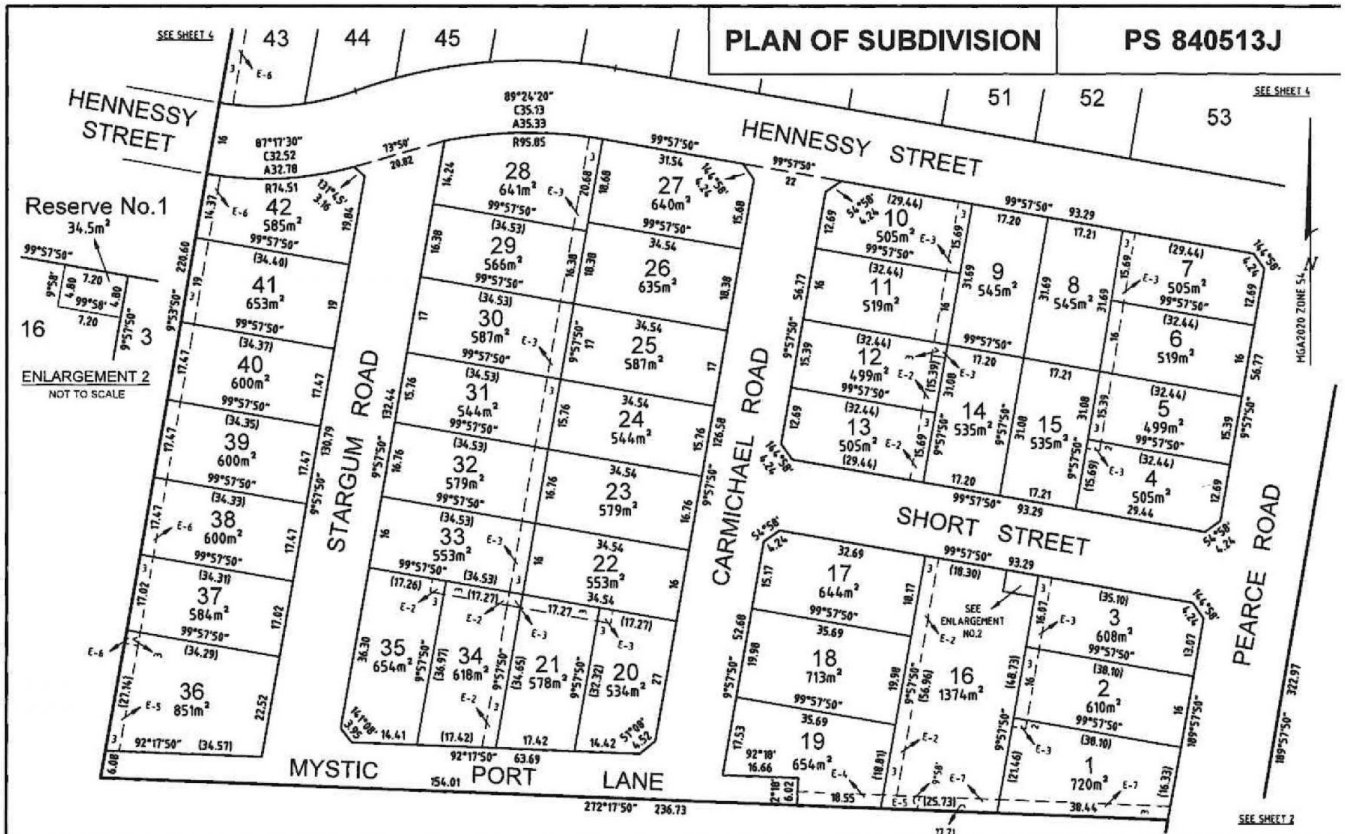

Smith Land Surveyors Pty Ltd  
 Office: 112a Flynn Street, South Geelong, Vic. 3220  
 P: 03 5222 1234 F: 03 5223 3141  
 E: survey@smiths.com.au  
 W: www.smithlandsurveyors.com.au  
 ABN 72 42 046 284

SCALE 1:750  
 7.5 0 7.5 15 22.5 30  
 LENGTHS ARE IN METRES

ORIGINAL SHEET  
 SIZE: A3

SHEET 3

LICENSED SURVEYOR Sebastian Willycombe

REFERENCE: 2020-0178POS VERSION: 12